



108A



308A



109



309



C-6080



C-5080

ALL CHAFERS COME COMPLETE WITH WATER AND FOOD PANS

THE VINTAGE LINE (EXTRA HEAVYWEIGHT)

Vintage line chafers are crafted with 18-10 stainless steel to present the highest quality of their kind. Frames are made with heavy 18-10 stainless steel. Handles and legs are fabricated from solid brass. The lid of the Venetian chafer can be opened and stopped at both 90° and 160° positions.

ITEM	DESCRIPTION	PACK
108A	Oblong, Full-Size, 8 Qt	1
308A	Round, 6 Qt, Rolltop	1

ACCESSORIES (FOR 108A, 308A, 309, 602)

ITEM	DESCRIPTION	PACK
308-6Q	Round, 6 Qt Food Pan for 308A, 309, 602	12
308-WP	Water Pan for 308A Oval Chafers, Soup Warmers & Coffee Urns	10
SPFD-2R	Round Divided Food Pan, S/S	10
C-F1	Fuel Holder w/Cover	24



308A



308-6Q

SPFD-2R

C-F1

THE VENETIAN LINE (EXTRA HEAVYWEIGHT) W/BRAKE

The Venetian Chafer has a built-in brake mechanism that allows the cover to open and stop at any position up to 180°. Accessories can be purchased separately.

ITEM	DESCRIPTION	PACK
109	Oblong, 8 Qt w/Brake	1
309	Round, 6 Qt w/Brake	1

Both units can be converted to soup tureen chafers by adding accessories.

DALLAS COLLECTION CHAFERS (HEAVYWEIGHT)

ITEM	DESCRIPTION	PACK
C-6080	Full-Size, Gold Accent, 8 Qt	1
C-5080	Rolltop, Gold Accent, 8 Qt	1
C-RTC	Rolltop Cover for C-5080	1



ALL 8 QUART CHAFERS WILL FIT FULL-SIZE FOOD PANS



MADISON COLLECTION CHAFERS, STAINLESS STEEL (HEAVYWEIGHT)

- Made of highly-polished stainless steel
- Rolltop covers can be opened and stopped at any position up to 180°
- Available in full-size oblong, round or oval styles

ITEM	DESCRIPTION	PACK
601	Full-size, 8 Qt	1
602	Round, 6 Qt	1
603	Oval, 7 Qt	1

ACCESSORIES FOR MADISON COLLECTION CHAFERS (601, 602, 603)

ITEM	DESCRIPTION	PACK
SPF2	Food Pan for 601	6
601-WP	Water Pan for 601, Mirror Finish	1
308-6Q	Food Pan for 602, 308A, 309	12
602-WP	Water Pan for 602	1
SPFD-2R	S/S Round Divided Food Pan for 602, 308A, 309	10



601



602



603



408-1



508



708



SPF2

308-6Q

601-WP

602-WP

SPFD-2R



CROWN COLLECTION CHAFERS

Exclusively designed for formal occasions: weddings, banquets, engagement parties. Finest quality and elegant details are perfect for your most discerning customers.

ITEM	DESCRIPTION	PACK
408-1	8 Qt Full-Size w/Dome Cover, Oblong	1
508	4 Qt Half-Size w/Dome Cover, Oblong	1
708	5 Qt w/Dome Cover, Round	1





201



202



203



C-3080B



C-3F



C-4F



C-2F

THE MALIBU COLLECTION GOLD-ACCENTED CHAFERS

IN THREE CONVENIENT SIZES:

- Oblong (8 Qt)
- Oval (6 Qt)
- Round (4 Qt)
- Cover conveniently clips onto frame

ITEM	DESCRIPTION	PACK
201	Oblong, 8 Qt	1
202	Oval, 6 Qt	1
203	Round, 4 Qt	1

ACCESSORIES FOR MALIBU CHAFERS

ITEM	DESCRIPTION	PRICE/PC	PACK
202-FP	Food Pan for 202	34.29	12
202-WP	Water Pan for 202	39.92	12
203-FP	Food Pan for 203	22.22	12
203-WP	Water Pan for 203	26.75	12



202-FP



202-WP

THE NEWBURG CHAFER

- Mirror-finished cover
- Each set comes with both metal and plastic handles
- Cover conveniently clips on to frame

ITEM	DESCRIPTION	PACK
C-3080B	Oblong 8 Qt	1



Handy lid clips hold lid in place

CHAFER STANDS

Fits only stainless steel pans & water pans. Do not use for aluminum foil pans.

ITEM	DESCRIPTION	PACK
C-3F	Wire	10
C-4F	Folding w/ Curved Legs	6

CHAFER STAND FOR ALUMINUM FOIL TRAYS

ITEM	DESCRIPTION	PACK
C-2F	Wire Stand	10

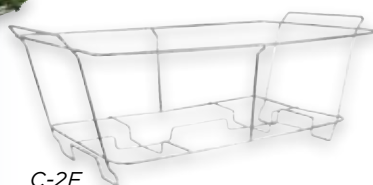

C-2F



GET-A-GRIP CHAFER WITH SPECIAL SAFETY FEATURE

NEW FEATURES:

- Stainless steel construction
- Patented food pan
- Handles on the food pan make for easy transport and help avoid steam burns

ITEM	DESCRIPTION	PACK
C-2080B	Oblong, 8 Qt	1
SPF2-HD	Food Pan with Handle	6



SPF2-HD



C-2080B

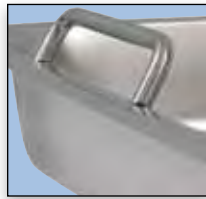

Patented Get-A-Grip handle system



Handy lid clips hold lid in place

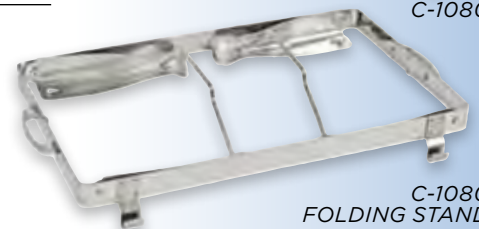

C-1080

C-1080
FOLDING STAND

BELLAIRE COLLECTION CHAFER (MIRROR FINISH)

FOLDING FRAME FEATURE:

- Allows for easier transport
- Saves storage space

ITEM	DESCRIPTION	PACK
C-1080	Chafers w/Folding Frame	1



PROFESSIONAL INDUCTION COOKER

- Easy for chefs to adapt to!
- Temperature is controlled by a unique knob, similar to one on a gas stove, with degrees Fahrenheit, heat levels and timer functions
- Surface is made of highly impact-resistant, German Schott ceramic glass
- 18 gauge, 304 stainless steel body
- Operates at wide temperature ranges (140°F - 460°F)
- ETL listed for sanitation and commercial electrical use
- 120V, 60Hz, 1800W
- One year warranty

ITEM	DESCRIPTION	PACK
EIC-18	20-11/16"L x 15-15/16"W x 6-5/16"H	2



EIC-18





EHL-2



PROFESSIONAL FREESTANDING HEAT LAMP

FOR RESTAURANT USE

- Extra heavy-duty 14 gauge anodized aluminum frame
- Aluminum light hood
- 4 position adjustable height
- Base: 14-1/4"D x 16-1/4"W
- Weight: 4.6 lbs.
- Voltage: 120V-/60Hz
- 6 foot power cord
- Includes 2 shatter resistant clear infrared, 250W/120V bulbs
- ETL listed for commercial appliance in US/Canada
- ETL sanitation listed (conforms to NSF-4 standard)
- One year warranty



ITEM	DESCRIPTION	PACK
EHL-2	19-1/2" L x 14-1/4" W x 23-1/2" H	1
EHL-BR	Replacement bulb for EHL-2, red	40
EHL-BW	Replacement bulb for EHL-2, clear	40



FW-S500



ELECTRIC FOOD WARMER, 1200W

- Standard opening - 20" x 12" - fits most full-size pans with depths of up to 6"
- Energy-efficient design for faster heating and lower utility costs
- Heavy-duty stainless steel body for commercial use
- Voltage: AC 120V, 60 HZ
- One year warranty



ITEM	DESCRIPTION	PACK
FW-S500	Outside: 22-1/2" L x 14-1/2" W x 9-1/2" H Inside: 20" L x 12" W x 6" H Weight: 20 lbs /9 kg	1



EWP-2



ELECTRIC CHAFER WATER PAN, 900W

- Adjustable temperature
- Stands alone or can also fit standard chafier frames

ITEM	DESCRIPTION	PACK
EWP-2	Full Size	1



Fits standard chafier pans



207

211

SOUP WARMERS, STAINLESS STEEL

Consists of cover, water pan, food pan, frame and fuel holder

ITEM	DESCRIPTION	PACK
207	7 Qt, S/S	1
211	11 Qt, S/S	1



207-WP

211-WP

WATER PANS FOR SOUP WARMERS

ITEM	DESCRIPTION	PACK
207-WP	For 207	12
211-WP	For 211	12



= Cash & Carry / Retail Packaging

SLIM BEVERAGE DISPENSER, STAINLESS STEEL

Size is only 9-3/4" in diameter, compared to 11" for the regular beverage dispenser - takes up less space on the counter or buffet table

ITEM	DESCRIPTION	PACK
SDBS-3	3 Gallon S/S	1



JUICE DISPENSERS

All juice dispensers are available in two styles:

- Two-tone with gold accents
- All stainless steel

ITEM	DESCRIPTION	PACK
901	2-Tone w/ gold Accents, 7-1/2 Qt	1
902	S/S, 7-1/2 Qt	1

ACCESSORIES FOR JUICE DISPENSERS

ITEM	DESCRIPTION	PACK
901-P1	PC Jar for 901 or 902	1
901-F	Faucet/Spigot for 901 or 902	1



INSULATED BEVERAGE SERVERS

- Molded polyethylene with polyurethane foam insulated walls
- Suitable for pre-dining and post-dining serving
- Molded without seams to maximize maintenance of proper beverage serving temperatures, eliminating leaking and saving valuable table or storage space
- Integrated molded handles for ease of transport
- The bottom interlocking mold system keeps your dispenser stable
- Stackable for storing convenience
- Recessed spigot location prevents leaking and dripping onto countertop surfaces, makes dispensing easier

ITEM	DESCRIPTION	PACK
IBS-2	2.5 Gallon, 9.4L / 40 Cups 16.5"D x 9"W x 18.375"H	1
IBS-4	4-3/4 Gallon, 18L / 76 Cups 16.5"D x 9"W x 24.25"H	1
IBS-11	11-3/4 Gallon, 44.5L / 188 Cups 20.75"D x 16.25"W x 24.75"H	1
IBS-24R	Riser for 2.5 Gal & 4-3/4 Gal Beverage Servers, 16.25"D x 9.125"W x 4.5625"H	1
IBS-11R	Riser for 11 Gal Beverage Server, 19.5"D x 15.375"W x 4.5"H	1

HOT

188°F	184°F	179.5°F	175°F	170.5°F

Starting Temperature	1 hour	2 hours	3 hours	4 hours
----------------------	--------	---------	---------	---------

COLD

33°F	34°F	36.5°F	37°F	38.5°F

Starting Temperature	1 hour	2 hours	3 hours	4 hours
----------------------	--------	---------	---------	---------



Recessed spigot prevents leakage

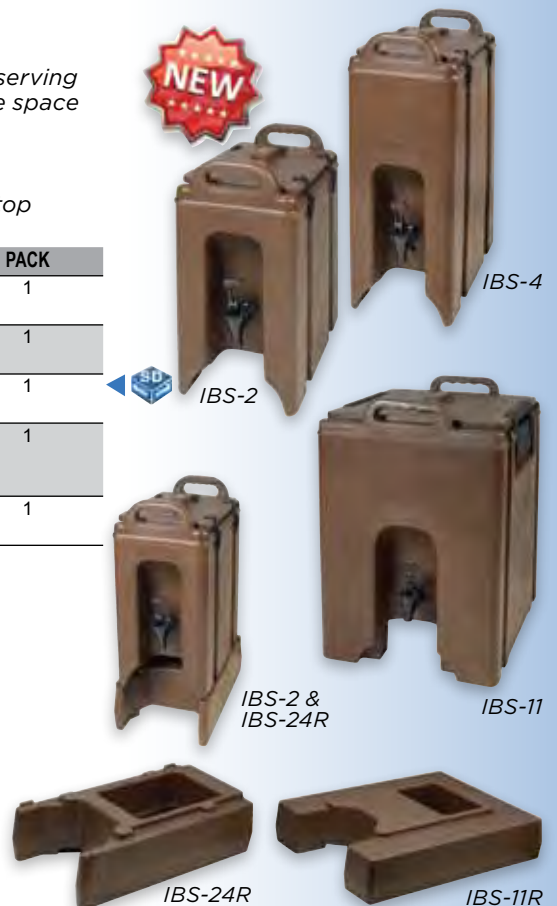

IBS-24R

IBS-11R



= Cash & Carry / Retail Packaging



DELUXE BUFFETWARE, S/S WITH HOLLOW HANDLE

ITEM	DESCRIPTION	SIZE	PACK
A	BW-NS3 Notched Spoon	11-3/4"	12
B	BW-SL2 Slotted Spoon	11-3/4"	12
C	BW-SS1 Solid Spoon	11-3/4"	12
D	BW-BF Pot Fork, Two Tines	11"	12
E	BW-CF Cold Meat Fork	10"	12
F	BW-PS5 Pie Server	11"	12
G	BW-WPS6 Wide Pie Server	11-1/2"	12
H	BW-DL Deep Ladle	4 Oz	12
I	BW-DK8 Carving Knife, Wave-Edge Blade	8"	12
J	BW-DK9 Slicer/Wedding Cake Knife, Wave-Edge Blade	9"	12
K	BW-SP1 Spout Ladle	1 Oz	12
L	BW-SP2 Spout Ladle	2 Oz	12
M	BW-TN Perforated Turner	14"	12



ELEGANCE GRAVY & SOUP LADLES, STAINLESS STEEL

ITEM	DESCRIPTION	PACK
LE-1	7" Gravy Ladle, 1 Oz	36
LE-2	9" Ladle, 2 Oz	12
LE-4	13" Ladle, 4 Oz	12



SERVING SPOONS, STAINLESS STEEL

ITEM	DESCRIPTION	PACK
SRS-2	Berry Spoon	25
SRS-8	Extra Heavy, 8-1/4" O.L. & 3" x 2-3/8" Bowl	25



SPAGHETTI SERVERS, STAINLESS STEEL

ITEM	DESCRIPTION	PACK
STS-9	9" S/S	12
STS-13	13" S/S	12



ELEGANCE SOLID SERVING SPOONS, STAINLESS STEEL

ITEM	DESCRIPTION	PACK
LE-11	11" Solid Spoon S/S	12
LE-13	13" Solid Spoon S/S	12

ELEGANCE FORK, STAINLESS STEEL

ITEM	DESCRIPTION	PACK
LE-20	13" Fork S/S	12

SALAD TONG, STAINLESS STEEL, HEAVY-DUTY

ITEM	DESCRIPTION	PACK
ST-10	10" S/S	6

PASTRY TONGS, STAINLESS STEEL

ITEM	DESCRIPTION	PACK
PT-8	7-1/2", Solid, S/S	12
PT-875	8-3/4" S/S	12



PT-875

ICE TONGS, STAINLESS STEEL

ITEM	DESCRIPTION	PACK
IT-7	7" Star, S/S	12



IT-7

SPAGHETTI TONGS, STAINLESS STEEL

ITEM	SIZE	PACK
ST-8	8" S/S	12

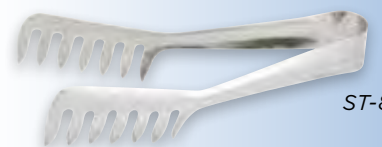

ST-8

OVAL SALAD TONG, STAINLESS STEEL

ITEM	SIZE	PACK
PTOS-8	7-3/4"	12



PTOS-8

FLAT TONGS, POLYCARBONATE

ITEM	SIZE	COLOR	PACK
PUTF-6B	6"	Beige	12
PUTF-6C	6"	Clear, NSF	12
PUTF-6K	6"	Black	12



PUTF SERIES

UTILITY TONGS, POLYCARBONATE

ITEM	SIZE	COLOR	PACK
PUT-6B	6"	Beige	12
PUT-6C	6"	Clear, NSF	12
PUT-6K	6"	Black	12
PUT-6R	6"	Red	12
PUT-9B	9"	Beige	12
PUT-9C	9"	Clear	12
PUT-9K	9"	Black	12
PUT-9R	9"	Red	12
PUT-9W	9"	White	12
PUT-12B	12"	Beige	12
PUT-12C	12"	Clear	12
PUT-12K	12"	Black	12
PUT-12R	12"	Red	12



PUT-6 SERIES



PUT-9 SERIES





PSS SERIES



PLD SERIES



PSSB SERIES



CMT-14



CMT-2014



CMT-1420



CMT-1318



CMT-1912



SMT-1



SMT-2

SERVING SPOONS, POLYCARBONATE

ITEM	SIZE	COLOR	PACK
PSS-13C	13"	Clear	12
PSS-13K	13"	Black	12
PSS-13R	13"	Red	12
PSS-15K	15"	Black	12

ONE-PIECE LADLES, POLYCARBONATE

ITEM	SIZE	COLOR	PACK
PLD-8B	3/4 Oz 8-1/2"	Beige	12
PLD-8C	3/4 Oz 8-1/2"	Clear, NSF	12
PLD-8K	3/4 Oz 8-1/2"	Black	12
PLD-8R	3/4 Oz 8-1/2"	Red	12
PLD-13B	1 Oz 13"	Beige	12
PLD-13C	1 Oz 13"	Clear, NSF	12
PLD-13K	1 Oz 13"	Black	12
PLD-13R	1 Oz 13"	Red	12

BUFFET SPOONS, 10", POLYCARBONATE

ITEM	SIZE	COLOR	PACK
PSSB-10B	3/4 Oz	Beige	12
PSSB-10C	3/4 Oz	Clear, NSF	12
PSSB-10K	3/4 Oz	Black	12
PSSB-10R	3/4 Oz	Red	12

CHROME-PLATED SERVING TRAYS

- The classic gadroon edge and traditional engraving make our chrome-plated trays attractive yet affordable
- Available in a variety of shapes and sizes
- Not recommended for prolonged use with meat or other acidic products

ROUND TRAY

ITEM	DIAMETER	PACK
CMT-14	14"	24

OBLONG TRAYS

ITEM	DIMENSIONS	PACK
CMT-1812	18" x 12-1/2"	24
CMT-2014	20" x 14"	24

OCTAGONAL TRAYS

ITEM	DIMENSIONS	PACK
CMT-1217	17" x 12-1/2"	24
CMT-1420	20" x 14"	24

OVAL TRAYS

ITEM	DIMENSIONS	PACK
CMT-1014	14-3/4" x 10-1/2"	24
CMT-1318	18-3/4" x 13"	24

OBLONG TRAY W/ HANDLES

ITEM	DIMENSIONS	PACK
CMT-1912	19-1/2" x 12-1/2"	24

6-COMPARTMENT TRAYS, STAINLESS STEEL

ITEM	DIMENSIONS	PACK
SMT-1	15-1/2" x 11-1/2"	24
SMT-2	15-1/2" x 11-1/2"	24

HOT/COLD FOOD TRANSPORTERS

- Carriers offer the perfect solution for transporting hot or cold foods
- Molded with polypropylene and insulated with polyurethane foam to insure maintenance of safe food serving temperatures for hours without the use of electric or sterno
- Adjustable vent cap equalizes outside and inside compartment pressure for easy lid opening
- Stackable and interlocking for space saving and easy storage
- Standard food service pans are easy to load and remove
- Holding compartments are easy to clean

FULL-SIZE HOT/COLD FOOD TRANSPORTERS

ITEM	DESCRIPTION	PACK
IFT-1	Insulated Food Pan Cart, Single	1
IFT-2	Insulated Food Pan Cart, Double	1
IFT-1D	Dolly for IFC-1, includes cargo strap	1



INTERIOR
VIEW IFT-1



IFT-1D (INCLUDES STRAP)
Can Also Be Used With IFPC Series



IFT-1 &
IFT-1D



IFT-1



IFT-2

SPECS OF FULL-SIZE HOT/COLD FOOD TRANSPORTERS

ITEM	DIMENSIONS	COMPARTMENT CAPACITY	
IFT-1	Exterior Dimensions	6 Full-Size, 2.5" Deep	8 Half-Size, 4" Deep
	18-3/4"W x 26-3/4"D x 24-1/2"H	4 Full-Size, 4" Deep	9 1/3 Size, 6" Deep
	Interior Dimensions	3 Full-Size, 6" Deep	12 1/3 Size, 4" Deep
	13-1/4"W x 21"D x 19-5/16"H	4 Half-Size, 6" Deep	6 1/3 Size, 8" Deep
IFT-2	20"W x 27-1/2"D x 47-1/4"H	Each of the two compartments can hold the following pans:	
	Interior Dimensions	4 Full-Size, 2-1/2" Deep	6 Half-Size, 4" Deep
	13-1/4"W x 16-1/8"D x 24-1/2"H	3 Full-Size, 4" Deep	4 Half-Size 6" Deep
		2 Full-Size, 6" Deep	6 1/3rd Size, 6" Deep
IFT-1D		10 Half-Size, 2-1/2" Deep	9 1/3rd Size, 4" Deep
		Used for All Sizes	

HOT	IFT	188°F	184°F	179°F	175.5°F	171.5°F
	IFPC	188°F	184.5°F	181.5°F	179°F	176°F
Starting Temperature		1 hour	2 hours	3 hours	4 hours	
COLD	IFT	33.8°F	34.6°F	35.4°F	36.3°F	37.1°F
	IFPC	32°F	33°F	34°F	35.5°F	36.5°F
Starting Temperature		1 hour	2 hours	3 hours	4 hours	

COMPACT HOT/COLD FOOD TRANSPORTERS

- Compact carriers offer the perfect solution for transporting hot or cold foods

ITEM	DESCRIPTION	PACK
IFPC-4	Insulated Food Pan Carrier, Up to 4" Deep Food Pans	1
IFPC-6	Insulated Food Pan Carrier, Up to 6" Deep Food Pans	1
IFPC-8	Insulated Food Pan Carrier, Up to 8" Deep Food Pans	1

SPECS OF COMPACT HOT/COLD FOOD TRANSPORTERS

ITEM	DIMENSIONS	COMPARTMENT CAPACITY
IFPC-4	Exterior Dimensions	Holds 4" Deep Pans,
	24-3/4"L x 17-1/4"W x 8-1/4"D Depth: 4"	1 Full-Size, 2 Half-Size 3 1/3 Size
IFPC-6	Exterior Dimensions	Holds 6" Deep Pans
	24-3/4"L x 17-1/4"W x 10-1/4"D Depth: 6"	1 Full-Size, 2 Half-Size 3 1/3 Size
IFPC-8	Exterior Dimensions	Holds 8" Deep Pans,
	24-3/4"L x 17-1/4"W x 12"D Depth: 8"	1 Full-Size, 2 Half-Size 3 1/3 Size



IFPC-4



IFPC-6



IFPC-8



IFPC-6 stackable view

Adjustable
Vent Cap
on Full-Size
& Compact
Transporters



= Cash & Carry / Retail Packaging